



# MASTERColour CDM-T Elite MW

MASTERColour CDM-TMW Elite 210W/930 1CT

The medium wattage lighting system that gives superior, longer-lasting white light for both indoor and outdoor use

## Product data

### • General Information

Cap base	PGZ18 [ PGZ18]
Bulb shape	TMW28 [ TMW 28mm]
Operating position	UNIVERSAL [ Any/Universal]
Life to 5% failures (nom.)	12500 h
Life to 10% failures (nom.)	16000 h
Life to 50% failures (nom.)	30000 h
ANSI code HID	C183/E
Features	na [ Not Applicable]

### • Light Technical

Luminous flux (rated) (min.)	22050 lm
Luminous flux (rated) (nom.)	24150 lm
Colour designation	Warm white (WW)
Lumen maintenance 12,000 hours (nom.)	90 %
Lumen maintenance 10,000 hours (nom.)	91 %
Lumen maintenance 2,000 hours (nom.)	98 %
Lumen maintenance 20,000 hours	81 %
Lumen maintenance – 40% life	90 %
Lumen maintenance 5,000 hours (nom.)	93 %
Lumen maintenance – 10% life	96 %
Saturated red	50
Design mean lumens	21735 lm

Chromaticity coordinate X (nom.)	0.438
Chromaticity coordinate Y (nom.)	0.399
Correlated colour temperature (max.)	- K
Correlated colour temperature (min.)	- K
Correlated colour temperature (nom.)	2940 K
Luminous efficacy (rated) (min.)	105 lm/W
Luminous efficacy (rated) (nom.)	115 lm/W
Color rendering index (min.)	87
Color rendering index (nom.)	90

### • Operating and Electrical

Power (Rated) (Nom)	210.0 W
Lamp current run-up (nom.)	3.2 A
Ignition supply voltage (max.)	4000 V
Ignition peak voltage (max.)	4000 V
Ignition supply voltage (min.)	2500 V
Re-ignition time (min.) (max.)	10 min
Ignition time (max.)	180 s
Voltage (Max)	115 V
Voltage (Min)	90 V
Voltage (Nom)	100 V

**PHILIPS**

## • Controls and Dimming

Run-up time 90% (max.) 1.5 min

## • Mechanical and Housing

Bulb finish Clear (CL)  
Maximum overall length (max.) 7.4 in

## • Approval and Application

Energy efficiency label (EEL) A+  
Picogram per lumen hour 40.4 pg/lm.h  
Mercury (Hg) content (max.) 24.5 mg  
Energy Consumption kWh/1000 h 231 kWh

## • UV

PET (NIOSH) (nom.) 64 h/500lx  
Damage factor D/fc (nom.) 0.15

## • Luminaire Design Requirements

Bulb temperature (max.) 600 °C  
Cap base temperature (nom.) 250 °C  
Pinch temperature (max.) 300 °C

## • Product Data

Full product code 871829113950800  
Order product name CDM-T Elite 210W/930 PGZ18.1CT/12  
EAN/UPC – product 8718291139508  
Order code 13950800  
Local Code 210CDMTELTE930  
Numerator – quantity per pack 1  
Numerator – packs per outer box 12  
Material no. (12NC) 928601164731  
Net weight (piece) 115.000 g  
ILCOS Code MT-210/30/1A-H-PGZ18

## Warnings and Safety

- Use only in totally enclosed luminaire, even during testing, except for protected versions with PGZX18 cap, which are designed for open luminaires (IEC61167, IEC 62035, IEC60598)
- The luminaire must be able to contain hot lamp parts if the lamp ruptures
- Use only with electronic control gear

- Control gear must include end-of-life protection (IEC61167, IEC 62035)
- A lamp breaking is extremely unlikely to have any impact on your health. If a lamp breaks, ventilate the room for 30 minutes and remove the parts, preferably with gloves. Put them in a sealed plastic bag and take it to your local waste facilities for recycling. Do not use a vacuum cleaner.

## Dimensional drawing

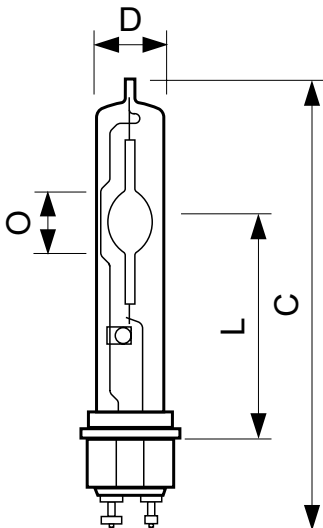

PGZX18/PGZX18., T12/TMW28

## CDM TMW 210W/930 PGZ18 U

Product	D	D	D	C	C
CDM-T Elite 210W/930 PGZ18.1CT/12	29 mm	1.1 in	28 mm	188 mm	186 mm

Dimensional drawing

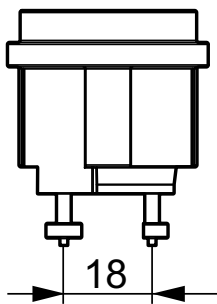
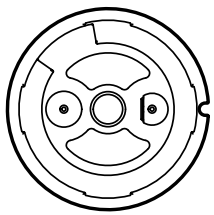

Photometric data

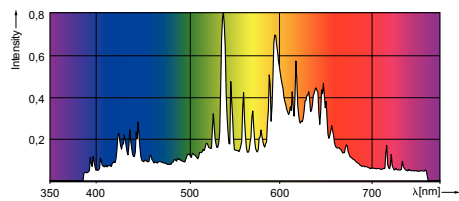

© 2016 Philips Lighting Holding B.V.  
All rights reserved.

Specifications are subject to change without notice. Trademarks are the property of Koninklijke Philips N.V. (Royal Philips) or their respective owners.

[www.philips.com/lighting](http://www.philips.com/lighting)

2016, July 4  
data subject to change