



AspiraVision Compact for CDM

HID-AV C 35-70 /I CDM 220-240V 50/60Hz

AspiraVision is the mark of excellence in HID electronic gear technology – high-end, compact, lightweight and easy to use, with added features for optimal performance of 35, 50 and 70 W CDM lamps. The recently added switching function provides maximum flexibility for users by integrating three different wattage choices into a single driver.

Product data

Operating and Electrical		Controls and Dimming	
Input Voltage	220 to 240 V	Control Interface	-
Line Frequency	50 to 60 Hz		
Input Frequency	50 to 60 Hz	Mechanical and Housing	
Earth Leakage Current (Max)	250 mA	Housing	/I
Inrush Current Width	10 ms		
Inrush Current Peak (Max)	8 A	Approval and Application	
Number of Products on MCB (16A Type B) (Nom)	58	Surge Protection (Common/Differential)	EN61547 (L-L 2kV, L-G 4kV) kV
		Safety Standard	EN 61347-2-12 and 2-1
		Approval Marks	EMC HEE F-Marking CE marking ENEC certificate VDE certificate CB Certificate VDE marking C-Tick certificate China Quality Certificate
Wiring		Product Data	
Cable Length From Device to Lamp	2 m	Full product code	871829123312100
Connector Type	WAGO series 804	Order product name	HID-AV C 35-70 /I CDM 220-240V 50/60Hz
		Order code	913700684066
Temperature		Numerator - Quantity Per Pack	1
Ambient temperature range	-20 °C to 45 °C	Numerator - Packs per outer box	12
T-Case Lifetime (Nom)	80 °C		

AspiraVision Compact for CDM

Material Nr. (12NC)	913700684066
Full product name	HID-AV C 35-70 /I CDM 220-240V 50/60Hz
EAN/UPC - Case	8718291233138

EAN/UPC - Product/Case	8718291233121
------------------------	---------------

Dimensional drawing

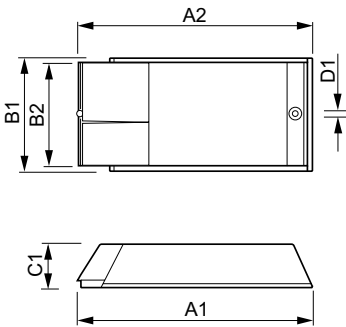

Product	D1	C1	A1	A2	B1
HID-AV C 35-70 /I CDM 220-240V 50/60Hz	4.8 mm	34.7 mm	189.2 mm	170.7 mm	83.5 mm

