

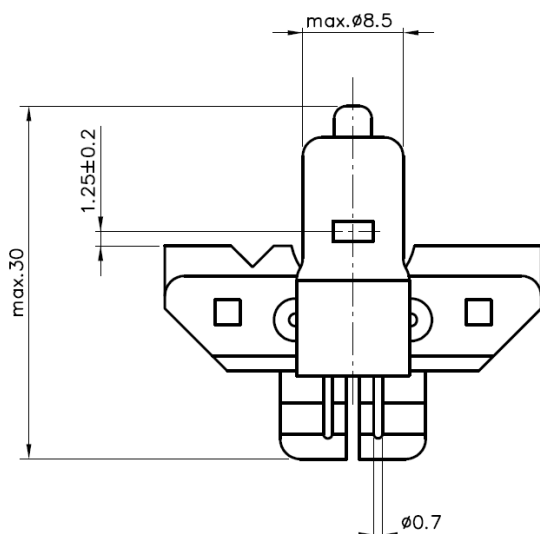

Medical

	Type SH5125 6V 10W PY16-1,25
	Ordering - No. 55125
Product Description	Halogen Lamp with Prefocus Base
Features	Quartz Bulb, Exactly positioned Filament
Applications	Medical, Microscope, Analysis

Drawing (in mm)



Technical Details

Category	HLWS5
Rated Voltage (V)	6
Wattage (W)	max. 11,0
Luminous Flux (lm)	150 ± 12%
Average Lifetime (h)	100
Base	PY16-1,25
Overall Length (mm)	max. 30
Bulb Diameter (mm)	max. 8,5
Light Center Length (mm)	1,25 ± 0,2
Operating Position	s90
Packaging Configuration	300 pcs.
Environmental Remark	Product don't contain lead or mercury and is conform with Directive 2002/95/EC "Restriction of the use of certain hazardous substances in electrical and electronic equipment".

valid from	05.03.2014—V2—PN14/0072
replace for	28.01.2013—V1
file	55125.100.pdf

MULTI-LITE GMBH is an official German distributor
for OSRAM, LEDVANCE, PHILIPS, GE and SLI
light bulbs and takes over your complete warranty
handling in case of damaged lamps or early failures.

Do you have any questions regarding this lamp or a fitting
replacement lamp?

Or would you like to get a manufacturer independent
consultancy?

We are looking forward hearing from you!

More information here:

Phone: **+49 40 / 66 99 30 - 0**

Fax: **+49 40 / 66 99 30 - 99**

Email: **global@multi-lite.com**

Web: **www.multi-lite.com**

**We stock almost every
specialty lamp ...!
Get in contact with us.**

MULTI-LITE Lichttechnik Handels GmbH
Managing Director: Wolfgang Massow
Senefelder-Ring 61
21465 Reinbek near Hamburg
Germany