

Medical

	Type SH5935 12V 100W GY6,35
	Ordering - No. 55935
Product Description	Special Halogen Lamp
Features	Quartz Bulb, Exactly positioned Filament
Applications	Medical, Microscope, Analysis

Technical Details

Category	HLWS7
Rated Voltage (V)	12
Wattage (W)	max. 110
Luminous Flux (lm)	2550 - 12%
Average Lifetime (h)	2000
Base	GY6,35 - 15
Overall Length (mm)	max.44,0
Bulb Diameter (mm)	max. 11,0
Light Center Length (mm)	30 ± 0,5
Packaging Configuration	100 pcs.
Environmental Remark	Product don't contain lead or mercury and is conform with Directive 2002/95/EC "Restriction of the use of certain hazardous substances in electrical and electronic equipment".

Drawing (in mm)

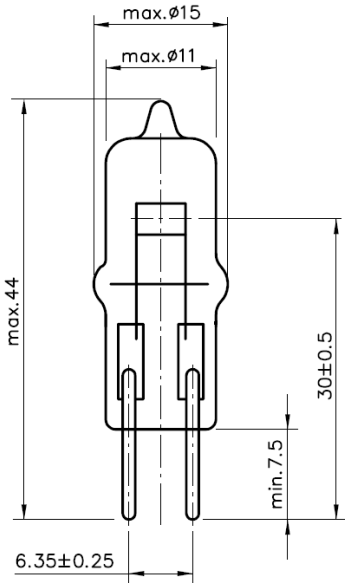

valid from	05.03.2014—V2—PN14/0072
replace for	29.01.2013—V1
file	55935.100.pdf



MULTI-LITE GMBH is an official German distributor
for OSRAM, LEDVANCE, PHILIPS, GE and SLI
light bulbs and takes over your complete warranty
handling in case of damaged lamps or early failures.

Do you have any questions regarding this lamp or a fitting
replacement lamp?

Or would you like to get a manufacturer independent
consultancy?

We are looking forward hearing from you!

More information here:

Phone: **+49 40 / 66 99 30 - 0**

Fax: **+49 40 / 66 99 30 - 99**

Email: **global@multi-lite.com**

Web: **www.multi-lite.com**

**We stock almost every
specialty lamp ...!
Get in contact with us.**

MULTI-LITE Lichttechnik Handels GmbH
Managing Director: Wolfgang Massow
Senefelder-Ring 61
21465 Reinbek near Hamburg
Germany