



CoreLine Wall-mounted

WL140V LED12S/840 PSED WH

CoreLine Wall-mounted, 13.5 W, D390 mm, 1250 lumen, 4000 K, DALI, IP65, EL-DC

CoreLine wall-mounted solutions deliver on the CoreLine promise of innovative, easy-to-install and high quality luminaires. These circular-shaped, surface-mounted luminaires are suitable for both ceiling and wall installations and are easy to apply in circulation areas such as corridors, hallways and staircases. The modern, unobtrusive design, combined with a homogeneous light distribution, ensures this luminaire will blend into the architecture of most buildings. And thanks to the push-in connectors, installation of the CoreLine WL140V is fast and straightforward. This family includes Interact ready luminaires with integrated wireless communications, ready for use with Interact gateways, sensors and software.

Product data

General Information		EU RoHS compliant	
Light source replaceable	No	Yes	
Number of gear units	1 unit		
Driver included	Yes		
Product family code	WL140V [Coreline Gen3 Wall Luminaire]		
Lighting Technology	LED		
Value ladder	Performance		
CE mark	Yes		
Warranty period	5 years		
Flammability mark	-		
ENEC mark	ENEC mark		
Glow-wire test	Temperature 850 °C, duration 30 s		
Light Technical			
Luminous Flux	1,250 lumen		
Saturated Red (R9)	<50		
Correlated Color Temperature (Nom)	4000 K		
Luminous Efficacy (rated) (Nom)	92 lm/W		
Color rendering index (CRI)	>80		
Flickering value (PstLM)	1		
Stroboscopic effect value (SVM)	1.6		
Beam angle of light source	120 degree(s)		
Light source color	840 neutral white		

CoreLine Wall-mounted

Optic type	Symmetrical
Luminaire light beam spread	120° x 120°
Unified glare rating CEN	22

Operating and Electrical

Input Voltage	220-240 V
Line Frequency	50 or 60 Hz
Initial CLO power consumption	- W
Inrush current	18 A
Inrush time	0.025 ms
Power Consumption	13.5 W
Power Factor (Fraction)	0.9
Connection	Push-in connector 6-pole
Cable	-
Number of products on MCB of 16 A type B	34

Temperature

Ambient temperature range	0 to +25 °C
---------------------------	-------------

Controls and Dimming

Dimmable	Yes
Driver/power unit/transformer	Power supply unit with DALI interface, DC compatible for central emergency lighting (integrated)
Control interface	DALI
Constant light output	No

Mechanical and Housing

Housing Material	Polycarbonate
Reflector material	Polycarbonate
Optic material	Polycarbonate
Optical cover/lens material	Polycarbonate
Fixation material	-
Housing Color	White
Optical cover/lens finish	Opal
Overall height	85 mm
Overall diameter	390 mm

Approval and Application

Ingress protection code	IP65 [Dust penetration-protected, jet-proof]
Mech. impact protection code	IK10 [20 J vandal-resistant]
Sustainability rating	-
Protection class IEC	Safety class II
Photobiological risk	Photobiological risk group 0 @200mm to EN62778
Photobiological risk specification	0.2 m

Initial Performance (IEC Compliant)

Initial chromaticity	(0.3818,0.3797) SDCM <3
Luminous flux tolerance	+/-10%
Power consumption tolerance	+/-10%

Over Time Performance (IEC Compliant)

Control gear failure rate at median useful life	5 %
50000 h	
Lumen maintenance at median useful life*	80
50000 h	

Application Conditions

Maximum dim level	1%
Performance ambient temperature Tq	25 °C
Suitable for random switching	No

Product Data

Full product code	871869997849500
Order product name	WL140V LED12S/840 PSED WH
Order code	910505101535
Numerator - Quantity Per Pack	1
Numerator - Packs per outer box	1
Material Nr. (12NC)	910505101535
Full product name	WL140V LED12S/840 PSED WH
EAN/UPC - Case	8718699978495
EAN/UPC - Product/Case	8718699978495

Dimensional drawing

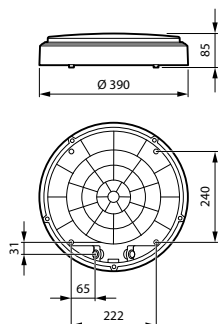

CoreLine Wall-mounted

