



# LuxSpace square, recessed

DN572B LED12S/830 DIA-VLC-E C WH

LuxSpace square, recessed, 9.9 W, 200x200 mm, 1300 lm, 3000 K, DALI, Interact Ready, UGR19, High-gloss reflector, VLC, IP20

Customers are looking to optimize all their resources, and that means not just their running costs (energy, etc.) but also their human resources. Energy savings are therefore a priority, but they must not have an adverse effect on the well-being of employees, who need a pleasant environment in order to be more productive, or on customers, who want to enjoy their shopping experience. LuxSpace provides the perfect combination of efficiency, light comfort and design, without compromising on lighting performance (color rendering and color uniformity). It offers a wide choice of options for creating the desired ambience, no matter the application.

## Product data

General Information	
Light source replaceable	No
Number of gear units	1 unit
Driver included	Yes
Service tag	Yes
Lighting Technology	LED
Value ladder	Specification
Warranty period	5 years
Sustainability rating	-
Light Technical	
Luminous Flux	1,300 lm
Correlated Color Temperature (Nom)	3000 K

Luminous Efficacy (rated) (Nom)	131 lm/W
Color rendering index (CRI)	>80
Light source color	830 warm white
Optic type	-
Luminaire light beam spread	80°
Unified glare rating CEN	19
Operating and Electrical	
Input Voltage	220 to 240 V
Line Frequency	50 to 60 Hz
Inrush current	16 A
Inrush time	0.195 ms
Power Consumption	9.9 W

LuxSpace square, recessed

Power Factor (Fraction)	0.9
Connection	Push-in connector and pull relief
Cable	-
Number of products on MCB of 16 A type B	24
Suitable for random switching	Yes
Protection class IEC	Safety class II
Total harmonic distortion	20 %

Controls and Dimming

Dimmable	Yes
Driver/power unit/transformer	Dali dimming Interact System ready visual light communicaton enabled external
Control interface	DALI
Constant light output	No
DALI Standard	D4i™ DALI-2™
Maximum dim level	1%
Connectivity	Interact Ready

Mechanical and Housing

Housing Material	Aluminum die cast
Reflector material	Polycarbonate aluminum coated
Optic material	Polycarbonate
Optical cover material	Polycarbonate
Fixation material	Steel
Housing Color	White
Optical cover finish	-
Reflector Finish	High-gloss reflector
Overall height	119 mm
Ingress protection code	IP20 [Finger-protected]
Mech. impact protection code	IK02 [0.2 J standard]
Net Weight (Piece)	1.500 kg

Approval and Application

Glow-wire test	Temperature 650 °C, duration 30 s
----------------	-----------------------------------

Flammability mark	For mounting on normally flammable surfaces
CE mark	Yes
ENEC mark	ENEC mark
EU RoHS compliant	Yes
Performance ambient temperature Tq	25 °C
Ambient temperature range	+10 to +25 °C

Initial Performance (IEC Compliant)

Luminous flux tolerance	+/-10%
Initial chromaticity	(0.43, 0.40) SDCM <2
Power consumption tolerance	+/-10%
Standard Deviation of Colour Matching (McAdam ellipse)	SDCM≤2

Over Time Performance (IEC Compliant)

Control gear failure rate at median useful life 50000 h	5 %
Lumen maintenance at median useful life* 50000 h	L90

Product Data

Order product name	DN572B LED12S/830 DIA-VLC-E C WH
Full product name	DN572B LED12S/830 DIA-VLC-E C WH
Full product code	871869997074100
Order code	910505100945
Material Nr. (12NC)	910505100945
Numerator - Quantity Per Pack	1
EAN/UPC - Product/Case	8718699970741
Numerator - Packs per outer box	1
EAN/UPC - Case	8718699970741
Product family code	DN572B [LuxSpace2 Square]

Dimensional drawing

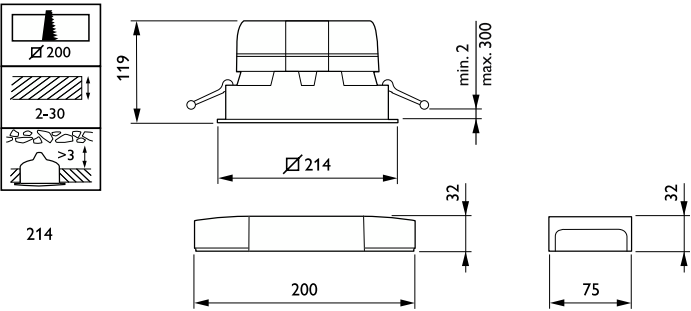

## LuxSpace square, recessed

