



Clearflood gen2

BVP656 LED600-4S/740 PSU DW10 ALU

Clearflood gen2, 341 W, 50490 lm, 4000 K, CRI70, Asymmetrical, IP66

This new generation of Clearflood range brings the total cost of ownership of your project to the next level. The range comes in 3 sizes (BVP655, BVP656, BVP657) with several finishing and serviceability options, and leverages on the light engine of our Recreational Sports & Area flagship floodlight. This light engine is optimized for sports applications, as well as large areas, such as logistical hubs, outdoor car parks and storage area. Now an innovative design approach allows the availability of connected options such as the SR socket, fully integrated on the floodlight housing, and a multi-sensor on the bracket. The product range is compatible with Interact systems.

Product data

General Information	
Lamp family code	LED600 [LED module 60000 lm]
Number of gear units	2 units
Driver included	Yes
Light source engine type	LED
Service tag	Yes
Value ladder	Specification
Warranty period	5 years
Sustainability rating	Lighting for circularity
Light Technical	
Upward light output ratio	0
Luminous Flux	50,490 lm
Correlated Color Temperature (Nom)	4000 K

Luminous Efficacy (rated) (Nom)	148 lm/W
Color rendering index (CRI)	70
Light source color	740 neutral white
Luminaire light beam spread	26° - 22° x 147°
Optic type outdoor	Asymmetrical
Effective projected area	0.22 m²
Operating and Electrical	
Input Voltage	230 V
Line Frequency	50 to 60 Hz
Inrush current	77 A
Inrush time	150 ms
Power Consumption	341 W
Power Factor (Fraction)	0.99

Clearflood gen2

Connection	Connection unit 3-pole
Cable	-
Number of products on MCB of 16 A type B	4
Protection class IEC	Safety class I
Surge Protection (Common/Differential)	6/8 kV
Total harmonic distortion	6.3 %

Controls and Dimming

Dimmable	No
Driver/power unit/transformer	Power supply unit
Control interface	-
Constant light output	No

Mechanical and Housing

Housing Material	Aluminium
Reflector material	-
Optic material	Acrylate
Optical cover material	Glass
Fixation material	Aluminum
Housing Color	Aluminum
Mounting device	Mounting bracket adjustable
Optical cover shape	Flat
Optical cover finish	Clear
Overall length	696 mm
Overall width	465 mm
Overall height	140 mm
Dimensions (Height x Width x Depth)	140 x 465 x 696 mm
Ingress protection code	IP66 [Dust penetration-protected, jet-proof]
Mech. impact protection code	IK08 [5 J vandal-protected]
Standard tilt angle posttop	-
Standard tilt angle side entry	-
Optical cover type	Clear glass
Net Weight (Piece)	16.000 kg

Approval and Application

Flammability mark	-
CE mark	Yes
ENEC mark	ENEC plus mark
EU RoHS compliant	Yes
Performance ambient temperature Tq	25 °C
Ambient temperature range	-40 °C to 50 °C

Initial Performance (IEC Compliant)

Luminous flux tolerance	+/-7%
Initial chromaticity	(0.329,0.342)
Power consumption tolerance	+/-10%
Init. Color Rendering Index Tolerance	-2

Over Time Performance (IEC Compliant)

Control gear failure rate at median useful life	10 %
100000 h	
Lumen maintenance at median useful life*	L95
100000 h	

Product Data

Order product name	BVP656 LED600-4S/740 PSU DW10 ALU
Full product name	BVP656 LED600-4S/740 PSU DW10 ALU
Full product code	872016979623200
Order code	912300060562
Material Nr. (12NC)	912300060562
Numerator - Quantity Per Pack	1
EAN/UPC - Product/Case	8720169796232
Numerator - Packs per outer box	1
EAN/UPC - Case	8720169796232
Product family code	BVP656 [CLEARFLOOD GEN2 MEDIUM]

Dimensional drawing

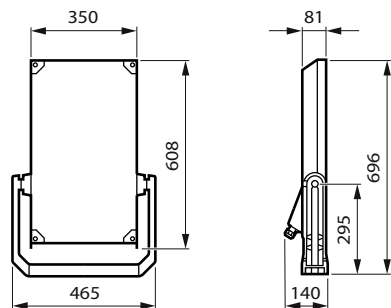

Clearflood gen2

