



Clearflood gen2

BVP656 LED600-4S/740 PSU A55-MB ALU

Clearflood gen2, 341 W, 49810 lm, 4000 K, CRI70, Asymmetrical, IP66

This new generation of Clearflood range brings the total cost of ownership of your project to the next level. The range comes in 3 sizes (BVP655, BVP656, BVP657) with several finishing and serviceability options, and leverages on the light engine of our Recreational Sports & Area flagship floodlight. This light engine is optimized for sports applications, as well as large areas, such as logistical hubs, outdoor car parks and storage area. Now an innovative design approach allows the availability of connected options such as the SR socket, fully integrated on the floodlight housing, and a multi-sensor on the bracket. The product range is compatible with Interact systems.

Product data

General Information			
Lamp family code	LED600 [LED module 60000 lm]	Luminous Efficacy (rated) (Nom)	146 lm/W
Number of gear units	2 units	Color rendering index (CRI)	70
Driver included	Yes	Light source color	740 neutral white
Light source engine type	LED	Luminaire light beam spread	5° - 17° x 97°
Service tag	Yes	Optic type outdoor	Asymmetrical
Value ladder	Specification	Effective projected area	0.22 m²
Warranty period	5 years	Operating and Electrical	
Sustainability rating	Lighting for circularity	Input Voltage	230 V
Light Technical		Line Frequency	50 to 60 Hz
Upward light output ratio	0	Inrush current	77 A
Luminous Flux	49,810 lm	Inrush time	150 ms
Correlated Color Temperature (Nom)	4000 K	Power Consumption	341 W
		Power Factor (Fraction)	0.99

Clearflood gen2

Connection	Connection unit 3-pole
Cable	-
Number of products on MCB of 16 A type B	4
Protection class IEC	Safety class I
Surge Protection (Common/Differential)	6/8 kV
Total harmonic distortion	6.3 %

Controls and Dimming

Dimmable	No
Driver/power unit/transformer	Power supply unit
Control interface	-
Constant light output	No

Mechanical and Housing

Housing Material	Aluminium
Reflector material	-
Optic material	Acrylate
Optical cover material	Glass
Fixation material	Aluminum
Housing Color	Aluminum
Mounting device	Mounting bracket adjustable
Optical cover shape	Flat
Optical cover finish	Clear
Overall length	696 mm
Overall width	465 mm
Overall height	140 mm
Dimensions (Height x Width x Depth)	140 x 465 x 696 mm
Ingress protection code	IP66 [Dust penetration-protected, jet-proof]
Mech. impact protection code	IK08 [5 J vandal-protected]
Standard tilt angle posttop	-
Standard tilt angle side entry	-
Optical cover type	Clear glass
Net Weight (Piece)	16.000 kg

Approval and Application

Flammability mark	-
CE mark	Yes
ENEC mark	ENEC plus mark
EU RoHS compliant	Yes
Performance ambient temperature Tq	25 °C
Ambient temperature range	-40 °C to 50 °C

Initial Performance (IEC Compliant)

Luminous flux tolerance	+/-7%
Initial chromaticity	(0.329,0.342)
Power consumption tolerance	+/-10%
Init. Color Rendering Index Tolerance	-2

Over Time Performance (IEC Compliant)

Control gear failure rate at median useful life	10 %
100000 h	
Lumen maintenance at median useful life*	L95
100000 h	

Product Data

Order product name	BVP656 LED600-4S/740 PSU A55-MB ALU
Full product name	BVP656 LED600-4S/740 PSU A55-MB ALU
Full product code	872016979620100
Order code	912300060559
Material Nr. (12NC)	912300060559
Numerator - Quantity Per Pack	1
EAN/UPC - Product/Case	8720169796201
Numerator - Packs per outer box	1
EAN/UPC - Case	8720169796201
Product family code	BVP656 [CLEARFLOOD GEN2 MEDIUM]

Dimensional drawing

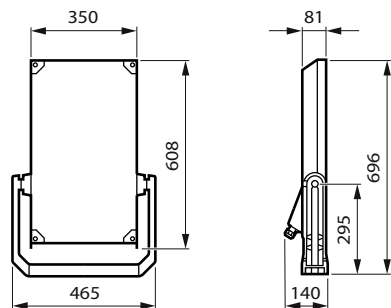

Clearflood gen2

