

ORIGINAL LINE H7

Original spare part



The cost-effective original spare parts

OSRAM ORIGINAL LINE halogen lamps offer convincing performance for standard requirements, are robust and cost-effective. They have already been successfully used in millions of new cars from renowned manufacturers, whether as standard initial equipment or original spare parts. Convince yourself of the excellent value for money, the reliable OEM quality and the wide product range of the ORIGINAL LINE.

Product datasheet

Technical data

Product information

| | |
|---|------------------------|
| Order reference | 64210 |
| Application (Category and Product specific) | Halogen headlight lamp |

Electrical data

| | |
|-----------------|--------------------|
| Power input | 58 W ¹⁾ |
| Nominal voltage | 12.0 V |
| Nominal wattage | 55.00 W |
| Test voltage | 13.2 V |

¹⁾ Maximum

Photometrical data

| | |
|-------------------------|---------|
| Luminous flux | 1500 lm |
| Luminous flux tolerance | ±10 % |

Dimensions & weight

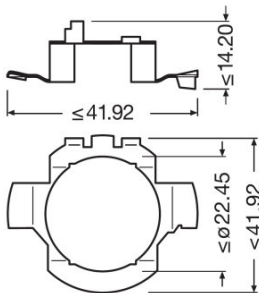

| | |
|----------------|---------|
| Diameter | 12.0 mm |
| Product weight | 12.50 g |
| Length | 59.0 mm |

Lifespan

| | |
|-------------|-------|
| Lifespan B3 | 330 h |
| Lifespan Tc | 550 h |

Additional product data

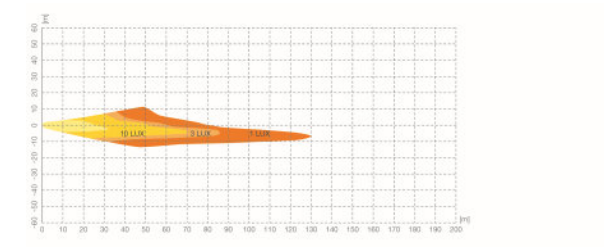

Luminous intensity distribution

| | |
|-----------------------------|-------|
| Base (standard designation) | PX26d |
|-----------------------------|-------|

Capabilities

| | |
|------------|-----|
| Technology | HAL |
|------------|-----|

Certificates & standards

| | |
|--------------|----|
| ECE category | H7 |
|--------------|----|

Country specific categorizations

| | |
|-----------------|-------|
| Order reference | 64210 |
|-----------------|-------|

Environmental information

| Information according Art. 33 of EU Regulation (EC) 1907/2006 (REACH) | |
|---|---|
| Date of Declaration | 05-03-2024 |
| Primary Article Identifier | 4050300459363 4050300925202 4050300479903 4050300332185 4008321006226 4008321023513 4050300722726 4008321642493 4052899056800 4052899277557 4052899408173 4052899411821 4052899475908 4052899593589 4062172131926 4052899980228 4062172387286 4062172395014 |

Product datasheet

| | |
|---|------------------------------------|
| Candidate List Substance 1 | No declarable substances contained |
| Declaration No. in SCIP database | In work |

Country specific information

| Product code | METEL code | SEG number | STK number | UK Org |
|---------------|--------------|------------|------------|--------|
| 4050300332185 | OSRA64210 | 8328066 | - | - |
| 4050300332192 | OSRA64210 | 8328066 | - | - |
| 4050300332185 | OSRA64210 | 8328066 | - | - |
| 4050300925202 | OSRA64210BL1 | 8328414 | 4730311 | - |
| 4050300925202 | OSRA64210BL1 | 8328414 | 4730311 | - |

Logistical Data

| Product code | Product description | Packaging unit (Pieces/Unit) | Dimensions (length x width x height) | Volume | Gross weight |
|---------------|---------------------|------------------------------|--------------------------------------|----------------------|--------------|
| 4050300332185 | ORIGINAL LINE H7 | Folding carton box 1 | 34 mm x 34 mm x 58 mm | 0.07 dm ³ | 16.00 g |
| 4050300332192 | ORIGINAL LINE H7 | Bundle 10 | 170 mm x 69 mm x 58 mm | 0.68 dm ³ | 161.00 g |
| 4050300332208 | ORIGINAL LINE H7 | Shipping carton box 100 | 356 mm x 186 mm x 129 mm | 8.54 dm ³ | 1762.00 g |
| 4050300925202 | ORIGINAL LINE H7 | Blister 1 | 135 mm x 95 mm x 35 mm | 0.45 dm ³ | 24.00 g |
| 4008321141613 | ORIGINAL LINE H7 | Shipping carton box 10 | 279 mm x 115 mm x 145 mm | 4.65 dm ³ | 330.00 g |

The mentioned product code describes the smallest quantity unit which can be ordered. One shipping unit can contain one or more single products. When placing an order, for the quantity please enter single or multiples of a shipping unit.

Download Data

| File |
|--|
|  360 Degree Image ORIGINAL H7 64210 |

Application advice

For more detailed application information and graphics please see product datasheet.

Disclaimer

Subject to change without notice. Errors and omission excepted. Always make sure to use the most recent release.

Product datasheet



OSRAM