

HBO 2002 W/MA

HBO-IC | Microlithography lamps for Canon i-line systems



Product datasheet

Technical data

Electrical data

Nominal current	54.0 A
Nominal voltage	37.0 V
Type of current	DC
Rated wattage	2000.00 W
Nominal wattage	2000.00 W

Dimensions & weight

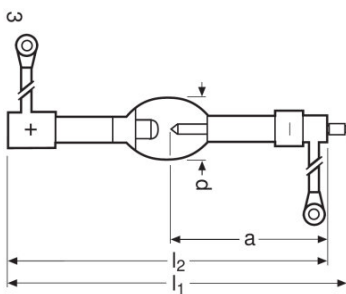

Diameter	62.0 mm
Length	270.0 mm
Electrode gap cold	3.0 mm

Capabilities

Dimmable	No
Burning position	Other ¹⁾

¹⁾ Anode underneath

Product datasheet

Safety advice

Because of their high luminance, UV radiation and high internal pressure (when hot) HBO lamps may only be operated in enclosed lamp casings specially constructed for the purpose. Mercury is released if the lamp breaks. Special safety precautions must be taken. More information is available on request or can be found in the leaflet included with the lamp or in the operating instructions.

Logistical Data

Product code	Product description	Packaging unit (Pieces/Unit)	Dimensions (length x width x height)	Volume	Gross weight
4050300628240	HBO 2002 W/MA	Folding carton box 1	605 mm x 230 mm x 320 mm	44.53 dm ³	2224.00 g
4050300732572	HBO 2002 W/MA	Folding carton box 4	321 mm x 579 mm x 246 mm	45.72 dm ³	2224.00 g
4050300628257	HBO 2002 W/MA	Shipping carton box 4	790 mm x 830 mm x 600 mm	393.42 dm ³	19914.00 g
4050300947259	HBO 2002 W/MA	Folding carton box 1	810 mm x 610 mm x 800 mm	395.28 dm ³	15680.00 g
4050300947266	HBO 2002 W/MA	Folding carton box 1	800 mm x 810 mm x 610 mm	395.28 dm ³	15680.00 g
4050300634418	HBO 2002 W/MA	Shipping carton box 1	800 mm x 810 mm x 610 mm	395.28 dm ³	15680.00 g

The mentioned product code describes the smallest quantity unit which can be ordered. One shipping unit can contain one or more single products. When placing an order, for the quantity please enter single or multiples of a shipping unit.

Disclaimer

Subject to change without notice. Errors and omission excepted. Always make sure to use the most recent release.
